

Ama-Drainer-Box – Waste Water Lifting Unit



Applications:

- Automatic drainage of building sections below the flood level
- Automatic disposal of domestic waste water from washing machines, wash basins, sinks, showers or bathtubs
- Overflow protection for rainwater harvesting systems or inlet tanks of fire-fighting systems
- Automatic drainage of rooms, garage driveways and cellars (frost-free) at risk of flooding

More information:

www.ksb.com/products

Your contact:



Ama-Drainer-Box – Waste Water Lifting Unit for Automatic Drainage of Water

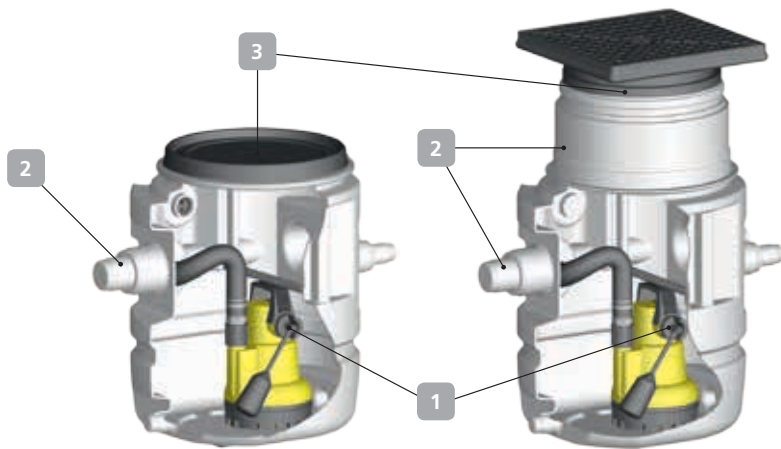

Reliable single or dual lifting units for underfloor or above-floor installation. Broad range of (Ama-Drainer) pumps, covering all possible application requirements.

Installation drawing:
above-floor box

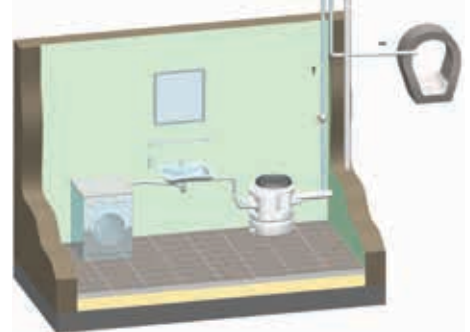

Installation drawing:
underfloor box

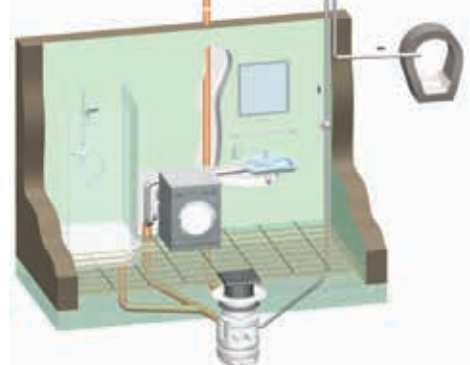

1 Maximum operating reliability

Absolute integrity and reliability: Patented magnetic switch with adjustable level control and maximum travel stop (Ama-Drainer N)

2 Flexible installation

Can be adapted to conditions or constraints on site thanks to level-adjustable, rotatable extension of the underfloor box and graded inlet connections

3 No bad odours

Drain with siphon trap integrated in the cover plate (underfloor) and odour-proof cover (above-floor)

Fast installation

Work on site is limited to fitting the inlet and discharge piping and connecting the unit to the power supply

Safety

Protection against penetrating groundwater: Puddle flange (accessory) available for sealing pipe passage through the wall of a “white tank” (waterproof concrete basement).

Technical data	Above-floor box 1 B Underfloor box 1 U Single-pump unit	Above-floor box Z 2 B Underfloor box Z 2 U Dual-pump unit
Flow rate Q	Up to 35 m ³ /h (9.7 l/s)	Up to 46 m ³ /h (12.8 l/s)
Head H	Up to 21 m	Up to 24 m
Fluid temperature t	Up to +40 °C in continuous operation Up to +90 °C for 3 minutes max.	Up to +40 °C in continuous operation Up to +90 °C for 3 minutes max.
Volume V	100 l	200 l

Automation option: LevelControl Basic 2



KSB Aktiengesellschaft
Johann-Klein-Straße 9
67227 Frankenthal (Germany)
www.ksb.com